

Data sheet

Modul surface mount housing 3 port pure white, unequipped

Page 1/6

P/N

130861-0302-E

EAN 4250184133001

2023/04/14

Version: R

Illustrations



Dimensional drawing

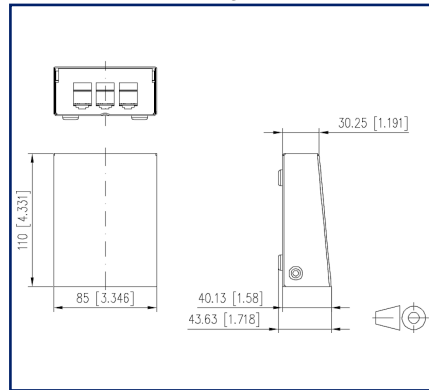

Drill pattern

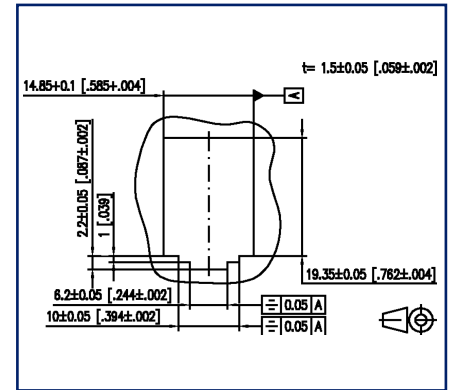

See enlarged drawings at the end of document

Product specification

- surface-mounted, unequipped module housing for individual modules in modul design
- solid steel sheet housing
- upper part of the housing powder-coated in RAL 9010
- upper part of the housing can be put on and removed easily because no screws are used for fastening
- equipotential bonding possible by means of contact pin
- additional strain relief on lower part of housing using cable ties
- suitable for direct wall mounting, as desktop device and for DIN-rail mounting using the DIN rail adapter mini FS
- bottom of the 3 port and 4 port housing can be removed. Additional fastening by means of 60 mm fastening clearance.
- optionally available and usable in all housings except 2 port: FO extension set for module and keystone surface mount housing: 130861-MSK-E
- optionally available 2x12 housing: Strain relief for patch cords 130861-24ZE-E
- variants: 2, 3, 4, 6, 8, 12, 16 and 2x12 ports

Modul surface mount housing 3 port pure white, unequipped

P/N

130861-0302-E

EAN 4250184133001

2023/04/14

Version: R

Technical Data

General Data

| | |
|---|-----------------------------------|
| Fields of application | office areas |
| Mechanical measurement according to MICE | M1 |
| Ingress measurement according to MICE | I1 |
| Climatic measurement according to MICE | C1 |
| Electromagnetic measurement according to MICE | E3 |
| Design | patch panel |
| Color | Pure white RAL 9010 |
| Dimensions | |
| Dimension (L x W x H) | 110 mm x 85 mm x 43.63 mm |
| Dimension (L x W x H) | 4.331 in. x 3.346 in. x 1.718 in. |
| Modularity | yes |

Connections/interfaces

| | |
|--------------------------------------|---|
| Number of ports interface 1 | 3 |
| Number of equipped ports interface 1 | 0 |
| Number of ports interface 2 | 3 |
| Number of ports interface 2 equipped | 0 |

Mechanical data

| | |
|---------------|-----------|
| Cut-out | module |
| strain relief | cable tie |

Materials and material properties

| | |
|------------------------|----------------------|
| Material - Housing | aluminium-zinc sheet |
| Material - Front cover | aluminium-zinc sheet |
| Material - Cover | steel |
| Halogen free | yes |
| RoHS | compliant |

Environmental conditions

| | |
|----------------------------|-----------------|
| Temperature (min. - max.) | |
| Temperature - Storage °C | -40 °C - 70 °C |
| Temperature - Storage °F | -40 °F - 158 °F |
| Temperature - Operating °C | -40 °C - 70 °C |

P | Cabling

Data sheet

Page 3/6

Modul surface mount housing 3 port pure white, unequipped

P/N

130861-0302-E

EAN 4250184133001

2023/04/14

Version: R

Technical Data

Environmental conditions

Temperature (min. - max.)

Temperature - Operating °F -40 °F - 158 °F

Classifications

| | |
|----------|----------|
| ETIM 5.0 | EC001128 |
| ETIM 6.0 | EC001128 |
| ETIM 7.0 | EC002006 |
| ETIM 8.0 | EC002006 |
| ETIM 9.0 | EC002006 |

Packing details

| | |
|---------------------------------|-----------------------------------|
| Type of packaging | 1 pc(s) / box |
| Packaging unit - Weight (gram) | 255 g |
| Packaging unit - Weight (pound) | 0.56 lb |
| Packaging dimension | 145 mm x 110 mm x 55 mm |
| Packaging dimension | 5.709 in. x 4.331 in. x 2.165 in. |



Modul surface mount housing 3 port pure white, unequipped

P/N

130861-0302-E

EAN 4250184133001

2023/04/14

Version: R

Accessories

| P/N | Designation |
|----------------|--|
| 130861-MSK-E | FO extension set for module and keystone surface mount housing |
| 130898-00-I | BLIND module light gray |
| 130898-00-RW-I | BLIND module pure white |
| 130898-01-I | COAX modul F jack / F jack |
| 130898-02-I | COAX modul IEC jack / F jack |
| 130898-03-I | COAX modul IEC plug / F jack |
| 1308990111-I | DIN rail adapter mini |
| 130908-I-B1 | UAE modul Cat.5e white |
| 130909-I | UAE modul Cat.6 jack T568A white |
| 130910-I | E-DAT modul Cat.6 _A 8(8) jack, T568A |
| 130910-I-B1 | E-DAT modul Cat.6 _A 8(8) jack, T568B |
| 130910-Z | E-DAT modul Cat.6 _A 8(8) jack, T568A (12 pcs) |
| 1309A0-I | E-DAT modul coupler 8(8) 180° class E _A |
| 130A11-29-I | UAE modul 8(8) Cat.6 _A black |
| 130A11-I | UAE modul 8(8) Cat.6 _A white |
| 130B11-25-E | 25Gmodul |
| 130B11-25-Z | 25Gmodul (12 pcs) |
| 130B11-E | C6 _A modul 180° jack |
| 130B11-Z | C6 _A modul 180° jack (12 pcs) |
| 15091001-I | OpDAT modul ST OS2 |
| 15091071-I | OpDAT modul LC-Duplex OS2 |
| 15091072-I | OpDAT modul LC-Duplex OM3 |
| 15091075-I | OpDAT modul LC-Duplex OM4 |
| 15091076-I | OpDAT modul LC-Duplex APC OS2 |
| 1509107B-I | OpDAT modul LC-Duplex OM2 |

P | Cabling

Data sheet

Page 5/6

Modul surface mount housing 3 port pure white, unequipped

P/N

130861-0302-E

EAN 4250184133001

2023/04/14

Version: R

Illustrations

Dimensional drawing

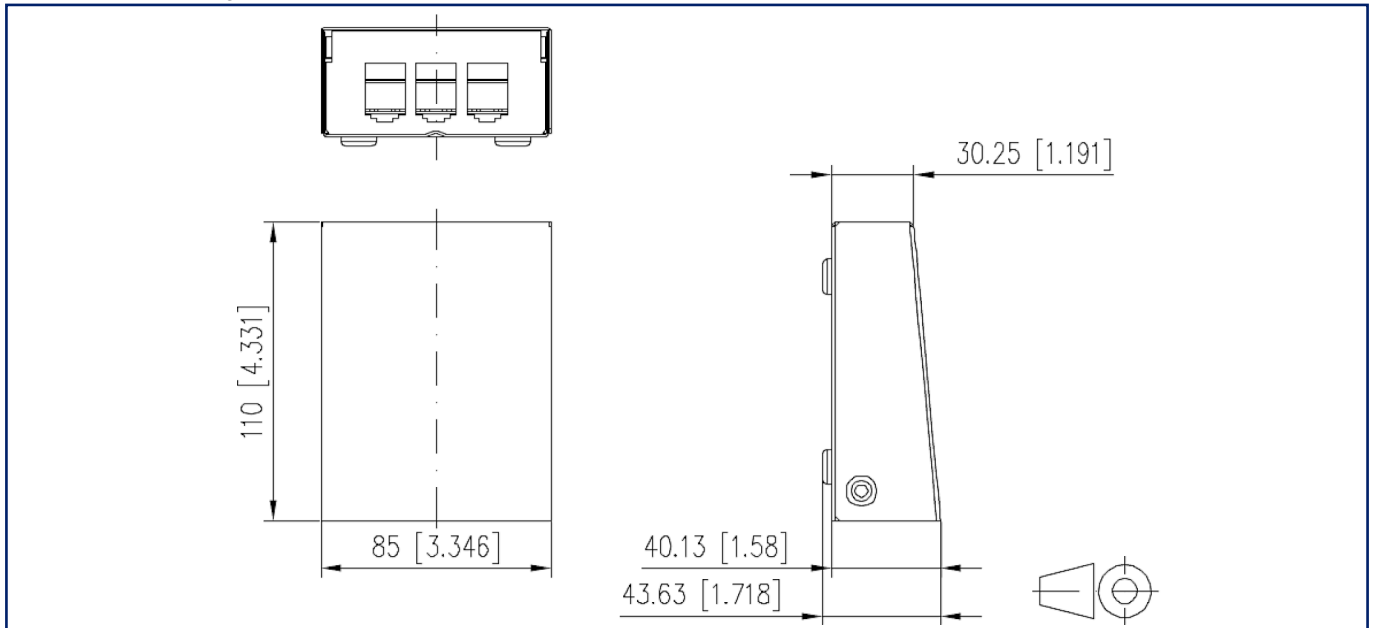

Drill pattern

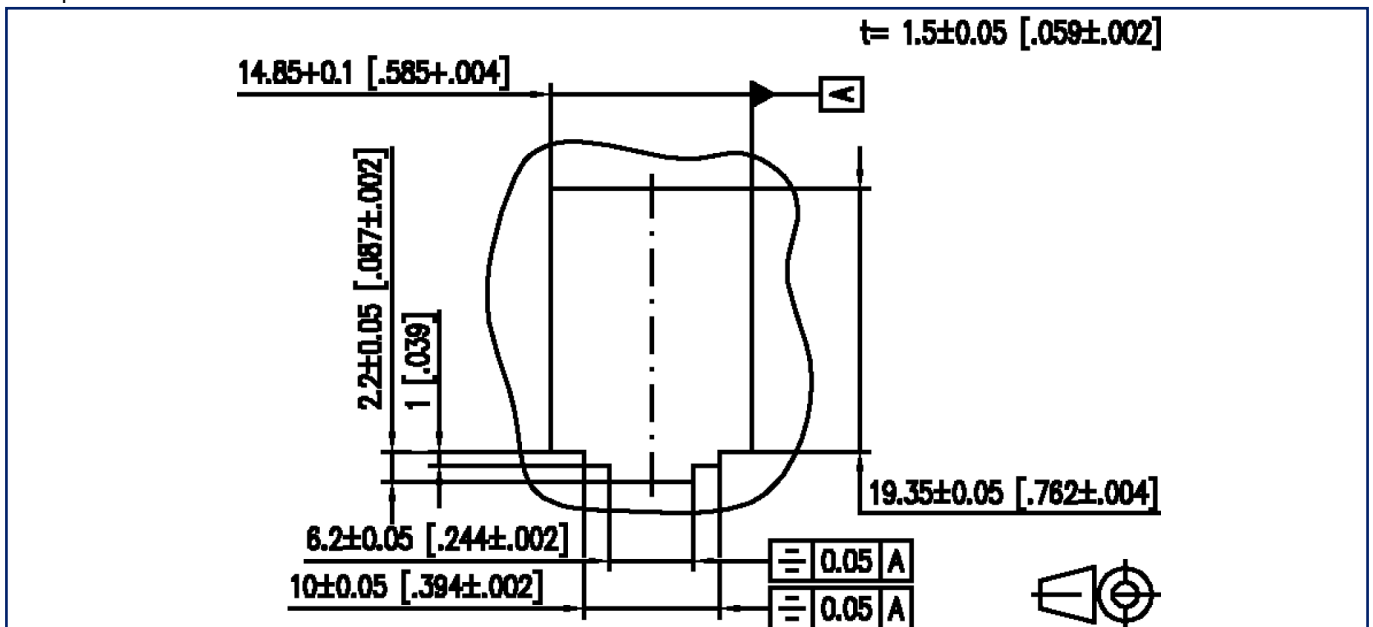

P | Cabling

Data sheet

Page 6/6

Modul surface mount housing 3 port pure white, unequipped

P/N

130861-0302-E

EAN 4250184133001

2023/04/14

Version: R

Illustrations

Cut-out

