

Data sheet

RW043xxHBLC Type 514

Page 1/6

P/N

315141xx

xx=number of poles

2025/04/30

Version: W

Illustrations



Dimensional drawing as an example

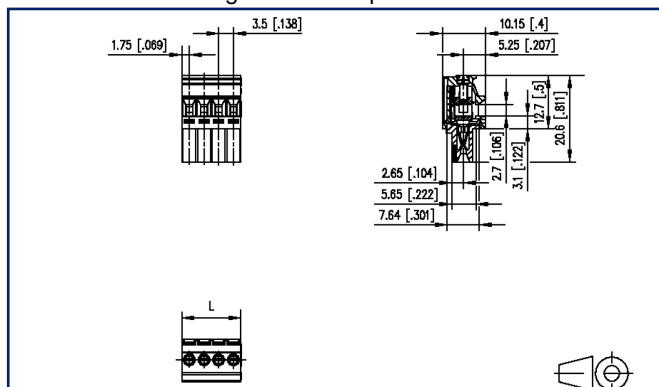

See enlarged drawings at the end of document

Product specification

- screw type terminal block, pluggable
- centerline 3.50 mm, direction of connection 90°
- lift system, fittable without loss of poles
- color black
- with alternative face, wire entry uncodeable side perpendicular to plug direction



U | Contact

Data sheet RW043xxHBLC Type 514

Page 2/6

P/N
315141xx

xx=number of poles

2025/04/30

Version: W

Technical Data

General Data

Tightening torque SEV	0.25 Nm		
Tightening torque UL	2.2 lb-in		
min. number of poles	2		
max. number of poles	24		
Insulating material class	CTI 600		
clearance/creepage dist.	2.7 mm		
Protection category	IP20		
Insul. strip length	7 mm		
Rated current	10 A		
Overvoltage category	III	III	II
Pollution degree	3	2	2
Rated voltage	160 V	400 V	400 V
Rated test voltage	4 kV	4 kV	4 kV

Terminal data

rat.wiring solid AWGmax	0.08 mm ² - 1.5 mm ² / AWG 28 - AWG 16
rat.wiring strand.AWGmax	0.08 mm ² - 1.5 mm ² / AWG 28 - AWG 16

Approvals

extended wiring UL	Wire range extended to No. 16 AWG solid only.
--------------------	---

 V / A / AWG	300 / 10 / 28 - 16
---	--------------------

approval UL - File No.	E121004
------------------------	---------

 130 V / 2.5 kV / 10 A	
---	--

Material

insulating material	PA66
flammability class	V0
contact material	CuSn
Contact surface	Sn
terminal body thread	M2
terminal body material	CuZnPb
terminal body surface	Ni
screw thread	M2

U | Contact

Data sheet

RW043xxHBLC Type 514

Page 3/6

P/N

315141xx

xx=number of poles

2025/04/30

Version: W

Technical Data

screw material	8,8
screw surface	Zn Cr(VI)-frei/free
Glow-Wire Flammability GWFI	960 °C acc. to IEC 60695-2-12
Glow-Wire Flammability GWIT	775 °C acc. to IEC 60695-2-13

Climatic Data

upper limit temperature	105 °C
lower limit temperature	-40 °C

general

Tolerance	ISO 2768 -mH
-----------	--------------

Application note

This product is a standard product of METZ CONNECT. METZ CONNECT is not aware of the specific intended use of the goods by the Customer or any customers of the Customer. The Customer guarantees that it has fully and sufficiently tested the use of the goods and any product modifications, product changes or product enhancements with regard to the specific intended use in accordance with the state of the art or in any other way. At METZ CONNECT's request, the Customer shall submit and make available meaningful evidence (e.g. test and laboratory protocols, certifications, etc.).



U | Contact

Data sheet

Page 4/6

RW043xxHBLC Type 514**P/N****315141xx****xx=number of poles**

2025/04/30

Version: W

Accessories

P/N	Designation
700268-01-0	F_Kodier sw
700268-0132	F_Kodier sw
700268-0194	F_Kodier sw



U | Contact

Data sheet

Page 5/6

RW043xxHBLC Type 514

P/N

315141xx**xx=number of poles**

2025/04/30

Version: W

Counterpart

P/N	Designation
315231	PW063xxHBBN Type 523
315241	PW063xxVBBN Type 524



U | Contact

Data sheet

RW043xxHBLC Type 514

Page 6/6

P/N

315141xx

xx=number of poles

2025/04/30

Version: W

Illustrations

Dimensional drawing as an example

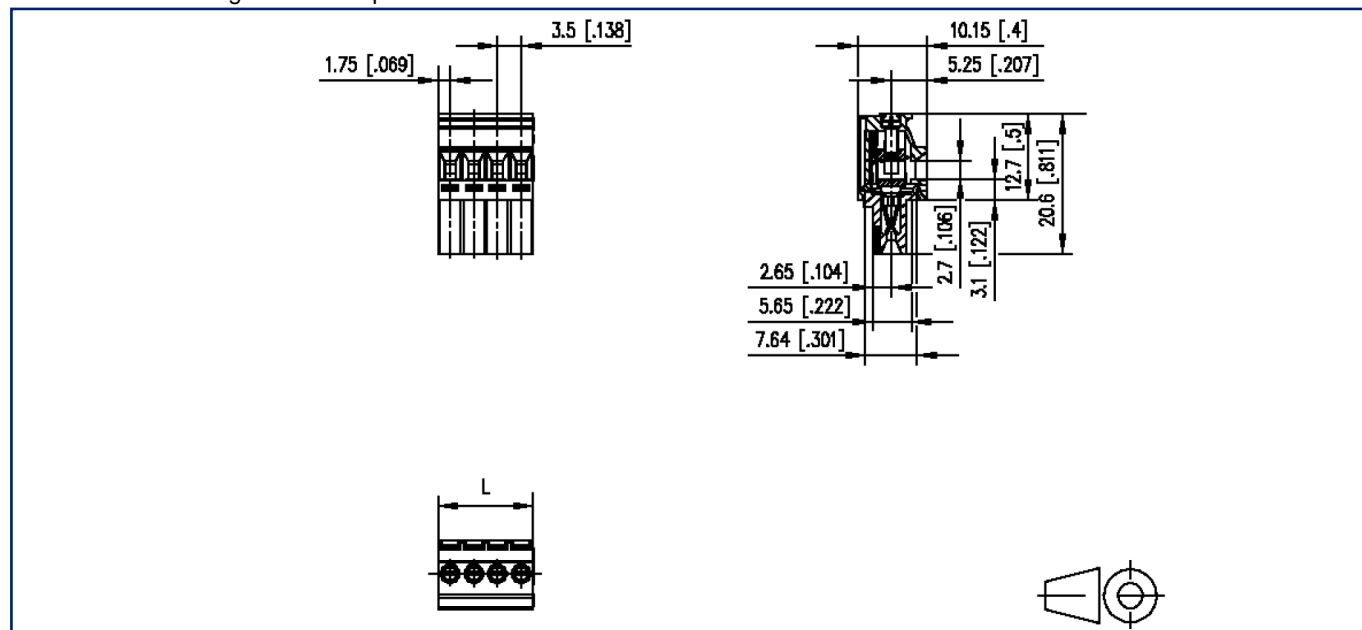

$L = (\text{pole size} - 1) \times \text{centerline} + 3.5 \text{ mm [0.138]}$