

## Data sheet Modul REGplus IP20 light gray unequipped

### Illustrations

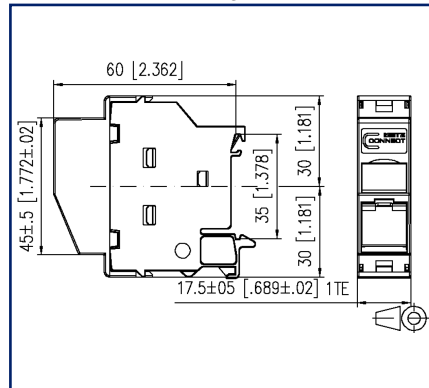

Dimensional drawing



Cut-out

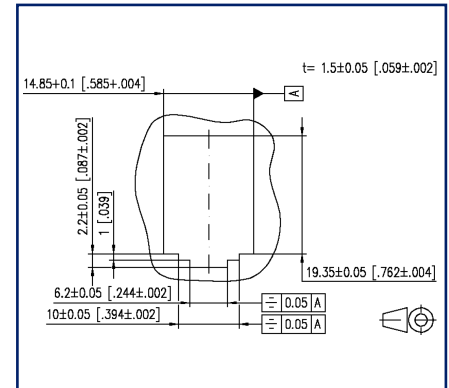

See enlarged drawings at the end of document

### Product specification

- unequipped termination unit for mounting on TH35 rail to DIN EN 60715
- for one individual module in Modul design
- variable cable feed 45° from the top or bottom, plug direction 45° downwards
- width of 1HP allows mounting up to 12 REG in standard electrical distribution panels
- when mounted as a device of protection class I, the equipotential bonding is realized directly over the rail by means of an integrated equipotential plate. Special measures have to be taken to integrate the rail in the equipotential bonding of the building.
- a cover protects the device against direct contact. If mounted in distributor panels with protective insulation, protection class II is guaranteed. In this case, it is necessary to remove the equipotential bonding plate.
- integrated dust protection cover (also colored)
- suitable modules for cable access 45° from the top: C6<sub>A</sub>modul 180°, E-DAT modul 8(8), E-DAT modul coupler 180°, UAE modul Cat.5e and Cat.6, OpDAT modul LC-D and ST, coax modules and E2000 DC couplers
- suitable modules for cable access 45° from the bottom: C6<sub>A</sub>modul 270° and E-DAT modul coupler 90°
- not suitable for modules in Keystone design and C6<sub>A</sub>modul 90°!



# P | Cabling

Data sheet

Page 2/6

## Modul REGplus IP20 light gray unequipped

P/N

1309427103-E

EAN 4250184136538

2024/11/12

Version: U

### Technical Data

#### General Data

Fields of application	harsh environment
Mechanical measurement according to MICE	M1
Ingress measurement according to MICE	I1
Climatic measurement according to MICE	C1
Electromagnetic measurement according to MICE	E3
Design	wall outlet
Color	light gray
Dimensions	
Dimension (L x W x H)	60 mm x 17.5 mm x 60 mm
Dimension (L x W x H)	2.362 in. x 0.689 in. x 2.362 in.
Horizontal pitch	1HP
Labeling option	label window with identification label
Marking option	by dust protection

#### Connections/interfaces

Number of ports interface 1	1
Number of equipped ports interface 1	0
Module plug-in direction	45° downwards
Cable access/outlet	variable, 45° from the top or bottom

#### Mechanical data

Cut-out	Module
---------	--------

#### Materials and material properties

Material - Cover part(s)	PA66
Material - Lower housing	PA66
Material - Ground connection	CuSn4
Material - Dust protection	ABS
Material - Label window	ABS, transparent
RoHS	compliant



# P | Cabling

Data sheet

Page 3/6

## Modul REGplus IP20 light gray unequipped

P/N

1309427103-E

EAN 4250184136538

2024/11/12

Version: U

### Technical Data

#### Environmental conditions

Particulate ingress	IP2X
Liquid ingress/immersion	IPX0

#### Approvals

UL listed (file no.)		DUXR.E178484
----------------------	--	--------------

#### Standards/Regulations

Mechanical fastening of electrical devices in switchgears	DIN EN 60715
---	--------------

#### Classifications

ETIM 7.0	EC001024
ETIM 8.0	EC001024
ETIM 9.0	EC001024

#### Packing details

Type of packaging	10 pc(s) / box
Packaging unit - Weight (gram)	286 g
Packaging unit - Weight (pound)	0.63 lb
Packaging dimension	235 mm x 165 mm x 135 mm
Packaging dimension	9.252 in. x 6.496 in. x 5.315 in.

#### Application note

This product is a standard product of METZ CONNECT. METZ CONNECT is not aware of the specific intended use of the goods by the Customer or any customers of the Customer. The Customer guarantees that it has fully and sufficiently tested the use of the goods and any product modifications, product changes or product enhancements with regard to the specific intended use in accordance with the state of the art or in any other way. At METZ CONNECT's request, the Customer shall submit and make available meaningful evidence (e.g. test and laboratory protocols, certifications, etc.).

## Modul REGplus IP20 light gray unequipped

P/N

1309427103-E

EAN 4250184136538

2024/11/12

Version: U

### Accessories

P/N	Designation
130898-00-I	BLIND module light gray
130898-00-RW-I	BLIND module pure white
130898-01-I	COAX modul F jack / F jack
130898-02-I	COAX modul IEC jack / F jack
130898-03-I	COAX modul IEC plug / F jack
130908-I-B1	UAE modul Cat.5e white
130909-I	UAE modul Cat.6 jack white
130910-DNV	E-DAT modul Cat.6 <sub>A</sub> 8(8) jack, T568A+T568B DNV
130910-I	E-DAT modul Cat.6 <sub>A</sub> 8(8) jack
130910-I-B1	E-DAT modul Cat.6 <sub>A</sub> 8(8) jack, T568B
130910-Z	E-DAT modul Cat.6 <sub>A</sub> 8(8) jack, (12 pcs)
1309A0-I	E-DAT modul coupler 8(8) 180° class E <sub>A</sub>
1309A1-I	E-DAT modul coupler 8(8) 90° class E <sub>A</sub>
130A11-29-I	UAE modul 8(8) Cat.6 <sub>A</sub> black
130A11-I	UAE modul 8(8) Cat.6 <sub>A</sub> white
130B11-25-E	25Gmodul
130B11-25-Z	25Gmodul (12 pcs)
130B11-DNV	C6 <sub>A</sub> modul 180° jack DNV
130B11-E	C6 <sub>A</sub> modul 180° jack
130B11-Z	C6 <sub>A</sub> modul 180° jack (12 pcs)
130B12-DNV	C6 <sub>A</sub> modul 270° jack DNV
130B12-E	C6 <sub>A</sub> modul 270° jack
1509005A-I	OpDAT adapter E2000-Duplex MM with Snap-In mounting
1509005B-I	OpDAT adapter E2000-Duplex OS2 with Snap-In mounting
1509005C-I	OpDAT adapter E2000-Duplex APC OS2 with Snap-In mounting
15091001-I	OpDAT modul ST OS2
15091070-I	OpDAT modul LC (Ph-Br) MM beige
15091071-I	OpDAT modul LC-Duplex OS2
15091072-I	OpDAT modul LC-Duplex OM3
15091075-I	OpDAT modul LC-Duplex OM4
15091076-I	OpDAT modul LC-Duplex APC OS2
1509107B-I	OpDAT modul LC-Duplex MM

# P | Cabling

Data sheet

Page 5/6

## Modul REGplus IP20 light gray unequipped

P/N

1309427103-E

EAN 4250184136538

2024/11/12

Version: U

### Accessories

816979-0103-I	Dust protection covers for Modul patch panels subway / REG gray
816979-0105-I	Dust protection covers for Modul patch panels subway / REG yellow
816979-0106-I	Dust protection covers for Modul patch panels subway / REG blue
816979-0107-I	Dust protection covers for Modul patch panels subway / REG green
816979-0108-I	Dust protection covers for Modul patch panels subway / REG red
899011-01	Label sheet for Modul patch panels / REG



# P | Cabling

Data sheet

Page 6/6

## Modul REGplus IP20 light gray unequipped

P/N

1309427103-E

EAN 4250184136538

2024/11/12

Version: U

### Illustrations

Dimensional drawing

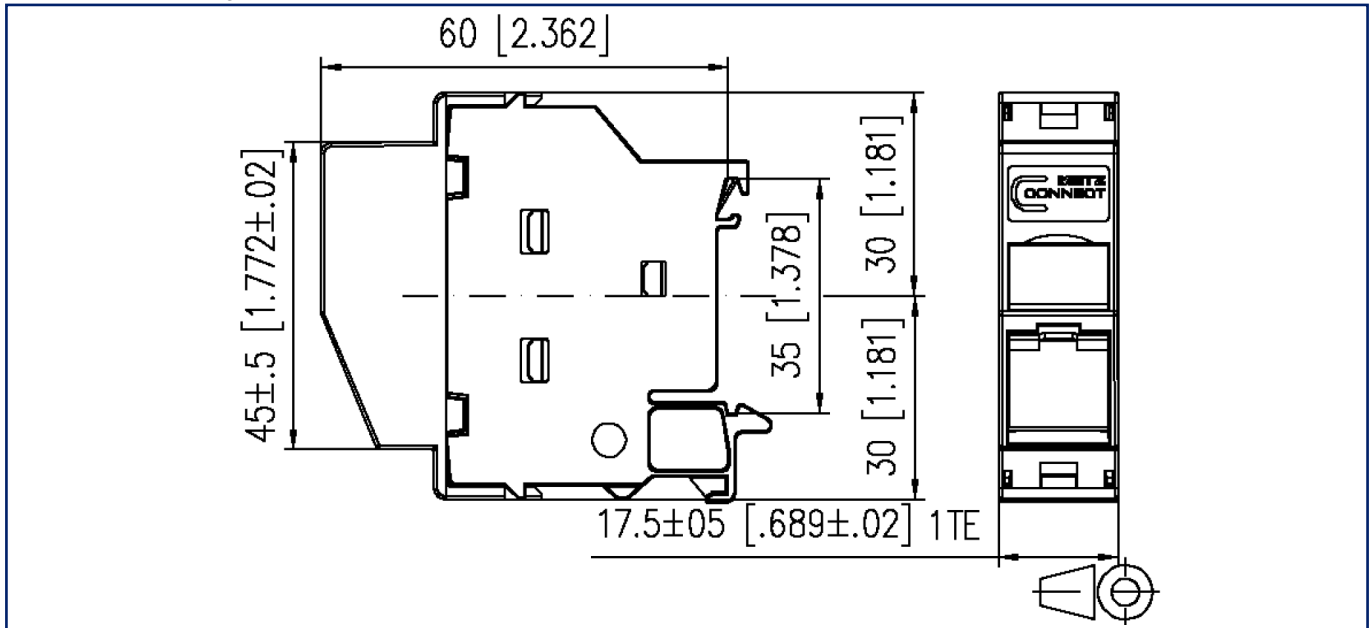

Cut-out

