

Data sheet

REGplus IP20 E-DAT modul coupler 90°

Illustrations



Dimensional drawing

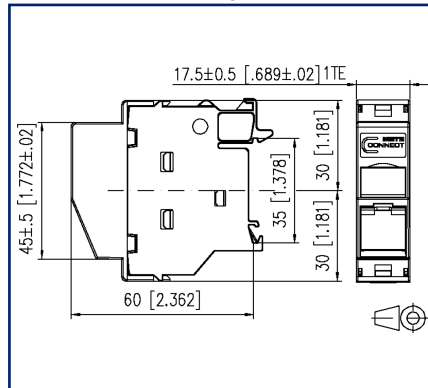

Cut-out

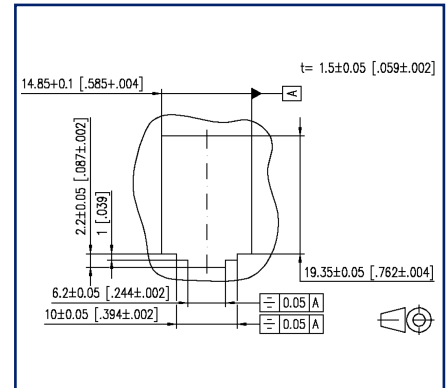

See enlarged drawings at the end of document

Product specification

- equipped with E-DAT modul RJ45 coupler
- plug direction 45° downwards
- compliance with class E_A according to ISO/IEC 11801, DIN EN 50173-1
- suitable for 10 GBit Ethernet (IEEE 802.3an), Remote Powering (PoE, PoE plus and UPoE) and HDBaseT
- width of 1HP allows mounting up to 12 REG plus in standard electrical distribution panels
- when mounted as a device of protection class I, the equipotential bonding is realized directly over the top hat rail by means of a switchable integrated equipotential spring. This has to be connected to the equipotential bonding of the building by means of a bonding terminal
- variants: E-DAT modul coupler 180°, E-DAT modul coupler 90°



P | Cabling

Data sheet

Page 2/7

REGplus IP20 E-DAT modul coupler 90°

P/N

1309A17003-E

EAN 4250184136521

2024/11/12

Version: AH

Technical Data

General Data

| | |
|-----------------------------------------------|----------------------------------------|
| Fields of application | office areas |
| Mechanical measurement according to MICE | M1 |
| Ingress measurement according to MICE | I1 |
| Climatic measurement according to MICE | C1 |
| Electromagnetic measurement according to MICE | E2 |
| Design | wall outlet |
| Mounting style | Standard rail TH35 |
| Shielding | shielded |
| Transmission technology | Copper |
| Color | light gray |
| Dimensions | |
| Dimension (L x W x H) | 60 mm x 17.5 mm x 60 mm |
| Dimension (L x W x H) | 2.362 in. x 0.689 in. x 2.362 in. |
| Horizontal pitch | 1HP |
| Labeling option | label window with identification label |
| Marking option | by dust protection |

Transmission characteristics

| | |
|---------------------------------|----------------|
| Category (ISO) | 6 |
| Class (ISO/IEC) | E _A |
| Category (TIA) | 6 |
| Remote Powering | yes |
| PoE | IEEE 802.3af |
| PoE plus | IEEE 802.3at |
| UPoE | yes |
| HDBaseT | yes |
| Transmission rate up to 10 GBit | IEEE 802.3an |



P | Cabling

Data sheet

Page 3/7

REGplus IP20 E-DAT modul coupler 90°

P/N

1309A17003-E

EAN 4250184136521

2024/11/12

Version: AH

Technical Data

Connections/interfaces

| | |
|------------------------------------------|---------------|
| Connector technology interface 1 | RJ45-jack |
| Connector technology interface 2 | RJ45-jack |
| Number of ports interface 1 | 1 |
| Number of ports interface 2 | 1 |
| Number of equipped ports interface 1 | 1 |
| Number of ports interface 2 equipped | 1 |
| Number of positions/contacts interface 1 | 8P/8C |
| Number of positions/contacts interface 2 | 8P/8C |
| Module plug-in direction | 45° downwards |

Electrical/ optical properties

| | |
|---------------------------|---------------|
| Current carrying capacity | max. 1 A |
| Contact resistance | max. 20 mOhm |
| Insulation resistance | min. 500 MOhm |

Materials and material properties

| | |
|------------------------------|-----------------------|
| Material - Housing | GD-Zn |
| Material - Cover part(s) | PA66 |
| Material - Lower housing | PA66 |
| Material - Label window | ABS, transparent |
| Material - Dust protection | ABS |
| Material - Contact | CuSn |
| Material - Contact finish | Ni + Au (nickel-gold) |
| Material - Finish | Ni (nickel) |
| Material - Ground connection | CuSn4 |
| RoHS | compliant |

Environmental conditions

| | |
|-----------------------------|----------------------------------------------------|
| Temperature (min. - max.) | |
| Temperature - Storage °C | -40 °C - 70 °C |
| Temperature - Storage °F | -40 °F - 158 °F |
| Temperature - Operating °C | -40 °C - 70 °C |
| Temperature - Operating °F | -40 °F - 158 °F |
| Rapid change of temperature | -40°C / -40°F - +70°C / 158°F / 25 cycles t=30 min |

Technical Data

Approvals

UL listed (file no.)



DUXR.E178484

Standards/Regulations

Connectors for electronic equipment

Free and fixed connectors

DIN EN 60603-7-51:2011-01

Connectors for electronic equipment - Tests and measurements

Test standard for connectors (engaging and separating connectors under electrical load)

DIN-EN 60512-99-001, Pg. UEL1

Endurance tests

IEC 60512-9-3: 03-2009

Interference proof

Immunity for industrial environments

DIN EN 61000-6-2:2006-03

Climate tests

IEC 60512-11

Classifications

ETIM 7.0

EC001024

ETIM 8.0

EC001024

ETIM 9.0

EC001024

Packing details

Type of packaging

10 pc(s) / box

Packaging unit - Weight (gram)

586 g

Packaging unit - Weight (pound)

1.29 lb

Packaging dimension

235 mm x 165 mm x 135 mm

Packaging dimension

9.252 in. x 6.496 in. x 5.315 in.

Application note

This product is a standard product of METZ CONNECT. METZ CONNECT is not aware of the specific intended use of the goods by the Customer or any customers of the Customer. The Customer guarantees that it has fully and sufficiently tested the use of the goods and any product modifications, product changes or product enhancements with regard to the specific intended use in accordance with the state of the art or in any other way. At METZ CONNECT's request, the Customer shall submit and make available meaningful evidence (e.g. test and laboratory protocols, certifications, etc.).



Accessories

| P/N | Designation |
|----------------|-------------------------------------------------------------------|
| 130898-00-I | BLIND module light gray |
| 130898-00-RW-I | BLIND module pure white |
| 130898-01-I | COAX modul F jack / F jack |
| 130898-02-I | COAX modul IEC jack / F jack |
| 130898-03-I | COAX modul IEC plug / F jack |
| 130908-I-B1 | UAE modul Cat.5e white |
| 130909-I | UAE modul Cat.6 jack white |
| 130910-DNV | E-DAT modul Cat.6 _A 8(8) jack, T568A+T568B DNV |
| 130910-I | E-DAT modul Cat.6 _A 8(8) jack |
| 130910-I-B1 | E-DAT modul Cat.6 _A 8(8) jack, T568B |
| 130910-Z | E-DAT modul Cat.6 _A 8(8) jack, (12 pcs) |
| 1309A0-I | E-DAT modul coupler 8(8) 180° class E _A |
| 1309A1-I | E-DAT modul coupler 8(8) 90° class E _A |
| 130A11-29-I | UAE modul 8(8) Cat.6 _A black |
| 130A11-I | UAE modul 8(8) Cat.6 _A white |
| 130B11-25-E | 25Gmodul |
| 130B11-25-Z | 25Gmodul (12 pcs) |
| 130B11-DNV | C6 _A modul 180° jack DNV |
| 130B11-E | C6 _A modul 180° jack |
| 130B11-Z | C6 _A modul 180° jack (12 pcs) |
| 130B12-DNV | C6 _A modul 270° jack DNV |
| 130B12-E | C6 _A modul 270° jack |
| 15091001-I | OpDAT modul ST OS2 |
| 15091071-I | OpDAT modul LC-Duplex OS2 |
| 15091072-I | OpDAT modul LC-Duplex OM3 |
| 15091075-I | OpDAT modul LC-Duplex OM4 |
| 15091076-I | OpDAT modul LC-Duplex APC OS2 |
| 1509107B-I | OpDAT modul LC-Duplex MM |
| 816979-0103-I | Dust protection covers for Modul patch panels subway / REG gray |
| 816979-0105-I | Dust protection covers for Modul patch panels subway / REG yellow |
| 816979-0106-I | Dust protection covers for Modul patch panels subway / REG blue |

P | Cabling

Data sheet

Page 6/7

REGplus IP20 E-DAT modul coupler 90°

P/N

1309A17003-E

EAN 4250184136521

2024/11/12

Version: AH

Accessories

| | |
|---------------|------------------------------------------------------------------|
| 816979-0107-I | Dust protection covers for Modul patch panels subway / REG green |
| 816979-0108-I | Dust protection covers for Modul patch panels subway / REG red |
| 899011-01 | Label sheet for Modul patch panels / REG |

P | Cabling

Data sheet

Page 7/7

REGplus IP20 E-DAT modul coupler 90°

P/N

1309A17003-E

EAN 4250184136521

2024/11/12

Version: AH

Illustrations

Dimensional drawing

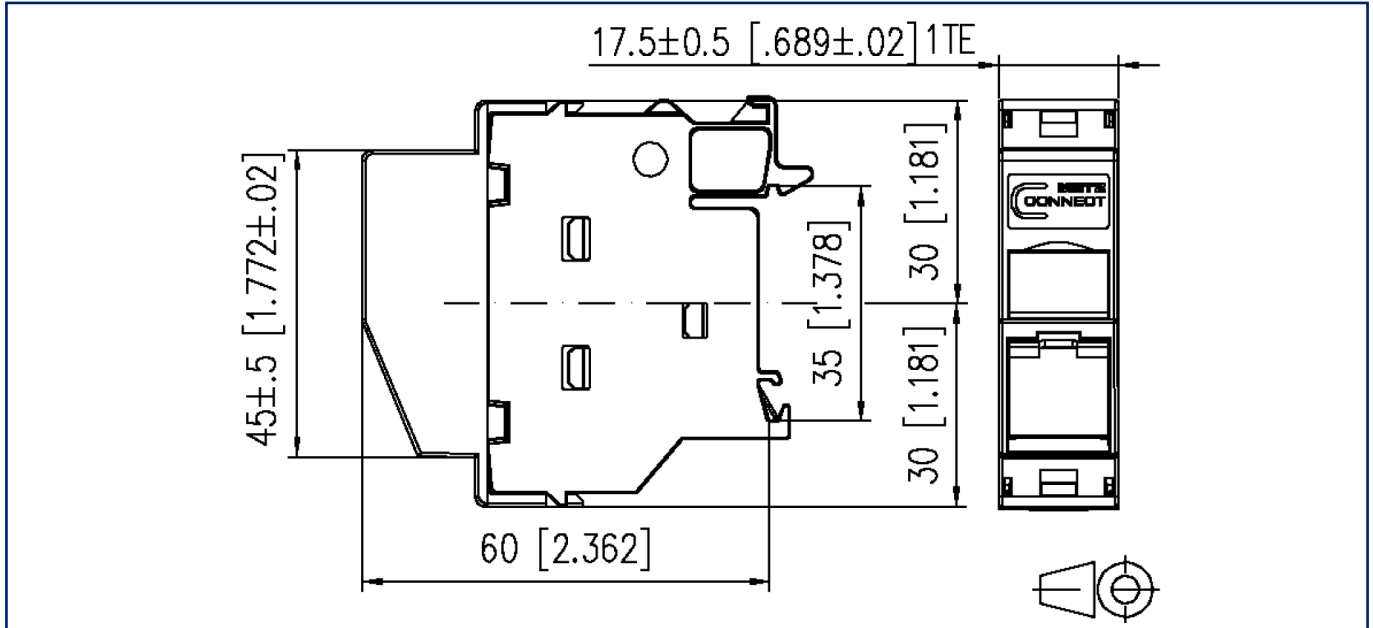

Cut-out

