

# Data sheet

## OpDAT Industry LC-D SM adapter insert

Page 1/5

P/N

1402L00820MI

EAN 4250184115908

2025/05/15

Version: X

### Illustrations



Dimensional drawing

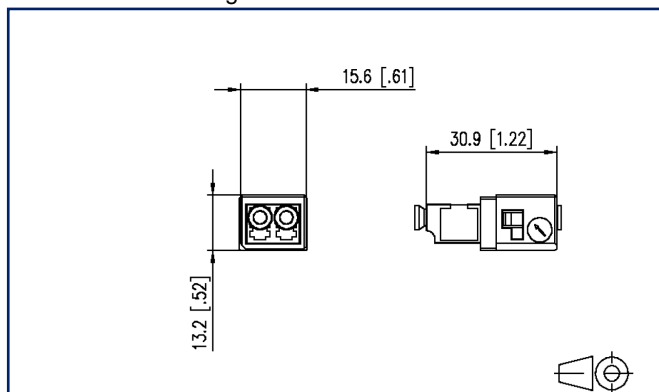

See enlarged drawings at the end of document

### Product specification

- LC-D adapter
- slotted ceramics sleeve for single mode applications
- slotted metal sleeve (Ph-Br) for multi mode applications
- conformity with relevant IEC framework specifications with regard to testing conditions and connector compatibility to connector version LC to IEC 61754-20
- compliance with EN 50173-1 or ISO/IEC 24702 with regard to the limits for insertion loss
- flame-retardant and halogen-free plastic housing
- flame-retardant and halogen-free dust cover
- in flange or wall outlet of var. 1 and 4 - suitable for integration
- variant 14 only available in sets
- service life: min. 500 plug-in cycles
- operating temperature -40 °C to +70 °C
- variants: blue (SM), beige (MM)



# Data sheet

## OpDAT Industry LC-D SM adapter insert

Page 2/5

P/N  
1402L00820MI  
EAN 4250184115908  
2025/05/15  
Version: X

### Technical Data

#### General Data

|   |                                  |
|---|----------------------------------|
| Mechanical measurement according to MICE      | M1                               |
| Ingress measurement according to MICE         | I1                               |
| Climatic measurement according to MICE        | C1                               |
| Electromagnetic measurement according to MICE | E3                               |
| Design  | coupler / adapter (FO)           |
| Transmission technology                       | Fiber optic                      |
| Color   | blue                             |
| Dimensions                                    |                                  |
| Dimension (L x W x H)                         | 30.9 mm x 15.6 mm x 13.2 mm      |
| Dimension (L x W x H)                         | 1.217 in. x 0.614 in. x 0.52 in. |
| Mode type of the fiber                        | Singlemode                       |
| Labeling option                               | on housing                       |

#### Connections/interfaces

|                      |    |
|----------------------|----|
| Connector interfaces | LC |
|----------------------|----|

#### Mechanical data

|  |                 |
|--|-----------------|
| Cut-out  | SC, LC-D, E2000 |
| Connector type   | duplex          |
| Life - Number of mating cycles                               | min. 1000       |
| Position/mounting of latch<br>standard installation position | top             |

#### Materials and material properties

|                            |                                  |
|----------------------------|----------------------------------|
| Material - Housing         | Plastics                         |
| Material - Sleeve          | ceramic, slotted                 |
| Material - Dust protection | flame retardant and halogen free |
| Halogen free               | yes                              |
| RoHS                       | compliant                        |



## Data sheet

Page 3/5

# OpDAT Industry LC-D SM adapter insert

P/N

1402L00820MI

EAN 4250184115908

2025/05/15

Version: X

## Technical Data

### Environmental conditions

Temperature (min. - max.)

Temperature - Storage °C -40 °C - 70 °C

Temperature - Storage °F -40 °F - 158 °F

Temperature - Operating °C -40 °C - 70 °C

Temperature - Operating °F -40 °F - 158 °F

### Standards/Regulations

Generic cabling systems

Industrial area ISO/IEC 24702 AMD 1 | DIN EN 50173-3  
ANSI/TIA-1005

Fibre optic connector interfaces LC - IEC 61754-20

### Classifications

ETIM 7.0 EC000752

ETIM 8.0 EC000752

ETIM 9.0 EC000752

### Packing details

Type of packaging 10 pc(s) / box

Packaging unit - Weight (gram) 91 g

Packaging unit - Weight (pound) 0.2 lb

Packaging dimension 89 mm x 250 mm x 105 mm

Packaging dimension 3.504 in. x 9.843 in. x 4.134 in.

### Application note

This product is a standard product of METZ CONNECT. METZ CONNECT is not aware of the specific intended use of the goods by the Customer or any customers of the Customer. The Customer guarantees that it has fully and sufficiently tested the use of the goods and any product modifications, product changes or product enhancements with regard to the specific intended use in accordance with the state of the art or in any other way. At METZ CONNECT's request, the Customer shall submit and make available meaningful evidence (e.g. test and laboratory protocols, certifications, etc.).



Data sheet

Page 4/5

OpDAT Industry LC-D SM adapter insert

P/N

1402L00820MI

EAN 4250184115908

2025/05/15

Version: X

Accessories from

| P/N             | Designation  |
|-----------------|--|
| 1401010110ME    | E-DAT Industry IP67 V1 1 port metal outlet                                 |
| 1401010220ME    | E-DAT Industry IP67 V1 2 port metal outlet                                 |
| 1401010620ME    | E-DAT Industry IP67 V1 2 port metal surface mount housing                  |
| 1401013300ME    | Industry IP67 V1 metal bulkhead  |
| 1401013300ME-F5 | Industry IP67 V1 metal bulkhead  |
| 1401013302KE    | Industry IP67 V1 bulkhead  |
| 1401040110ME    | E-DAT Industry IP67 V4 1 port metal outlet                                 |
| 1401040220ME    | E-DAT Industry IP67 V4 2 port metal outlet                                 |
| 1401040620ME    | E-DAT Industry IP67 V4 2 port metal surface mount housing                  |
| 1401043302KE    | Industry IP67 V4 bulkhead  |
| 14040000-E      | MCO IP69k protective housing for outdoor use, set for exposed installation |
| 14040010-E      | MCO IP69k Protective housing for outdoor use, set with mounting bracket    |
| 14040100-E      | MCO IP69k Protective housing for outdoor use, set wall/ housing bushing    |

Data sheet

Page 5/5

## OpDAT Industry LC-D SM adapter insert

P/N

1402L00820MI

EAN 4250184115908

2025/05/15

Version: X

### Illustrations

Dimensional drawing

