

Data sheet

PR055xxVBHC Type 048

Page 1/6

P/N

310481xx

xx=number of poles

2025/04/16

Version: AA

Illustrations



Dimensional drawing as an example

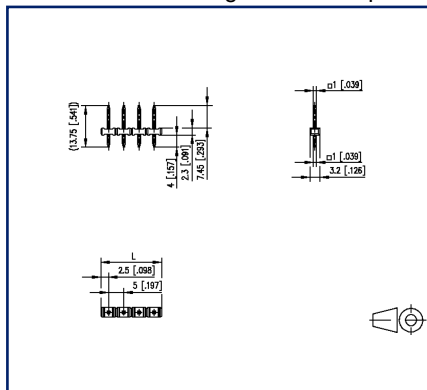

Drill pattern as an example

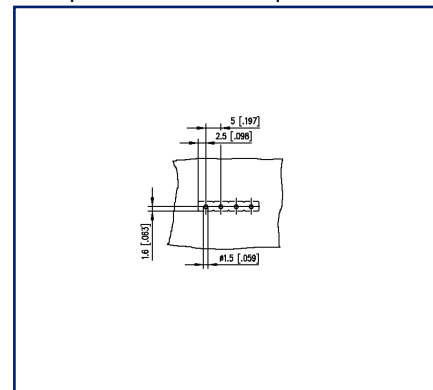

See enlarged drawings at the end of document

Product specification

- pin header, THR solderable
- centerline 5.00 mm, direction of connection vertical 0°
- fittable without loss of poles
- color black
- Tape & Reel packaging possible



U | Contact

Data sheet PR055xxVBHC Type 048

Page 2/6

P/N
310481xx

xx=number of poles

2025/04/16



Version: AA

Technical Data

General Data

Solder pin length	4 mm		
min. number of poles	2		
max. number of poles	24		
Insulating material class	CTI 400		
clearance/creepage dist.	4 mm		
Protection category	IP00		
Rated current	15 A		
Overvoltage category	III	III	II
Pollution degree	3	2	2
Rated voltage	250 V	500 V	500 V
Rated test voltage	6 kV	6 kV	6 kV

Approvals

 V / A	300 / 15
approval UL - File No.	E121004
	320 V / 4 kV / 13.5 A / 1.0 x 1.0 mm

Material

insulating material	PA46
flammability class	V0
contact pin material	CuFeP
contact pin surface	Ni + Sn
Glow-Wire Flammability GWFI	-
Glow-Wire Flammability GWIT	-

Climatic Data

upper limit temperature	105 °C
lower limit temperature	-40 °C

general

Tolerance	ISO 2768 -mH
Solderability	reflowable

Application note

U | Contact

Data sheet**Page 3/6****PR055xxVBHC Type 048****P/N****310481xx****xx=number of poles**

2025/04/16

Version: AA

Technical Data

This product is a standard product of METZ CONNECT. METZ CONNECT is not aware of the specific intended use of the goods by the Customer or any customers of the Customer. The Customer guarantees that it has fully and sufficiently tested the use of the goods and any product modifications, product changes or product enhancements with regard to the specific intended use in accordance with the state of the art or in any other way. At METZ CONNECT's request, the Customer shall submit and make available meaningful evidence (e.g. test and laboratory protocols, certifications, etc.).



U | Contact

Data sheet

Page 4/6

PR055xxVBHC Type 048

P/N

310481xx**xx=number of poles**

2025/04/16

Version: AA

Counterpart of

P/N	Designation
312071	RP025xxHBLC Type 207



U | Contact

Data sheet

PR055xxVBHC Type 048

Page 5/6

P/N

310481xx

xx=number of poles

2025/04/16

Version: AA

Illustrations

Dimensional drawing as an example

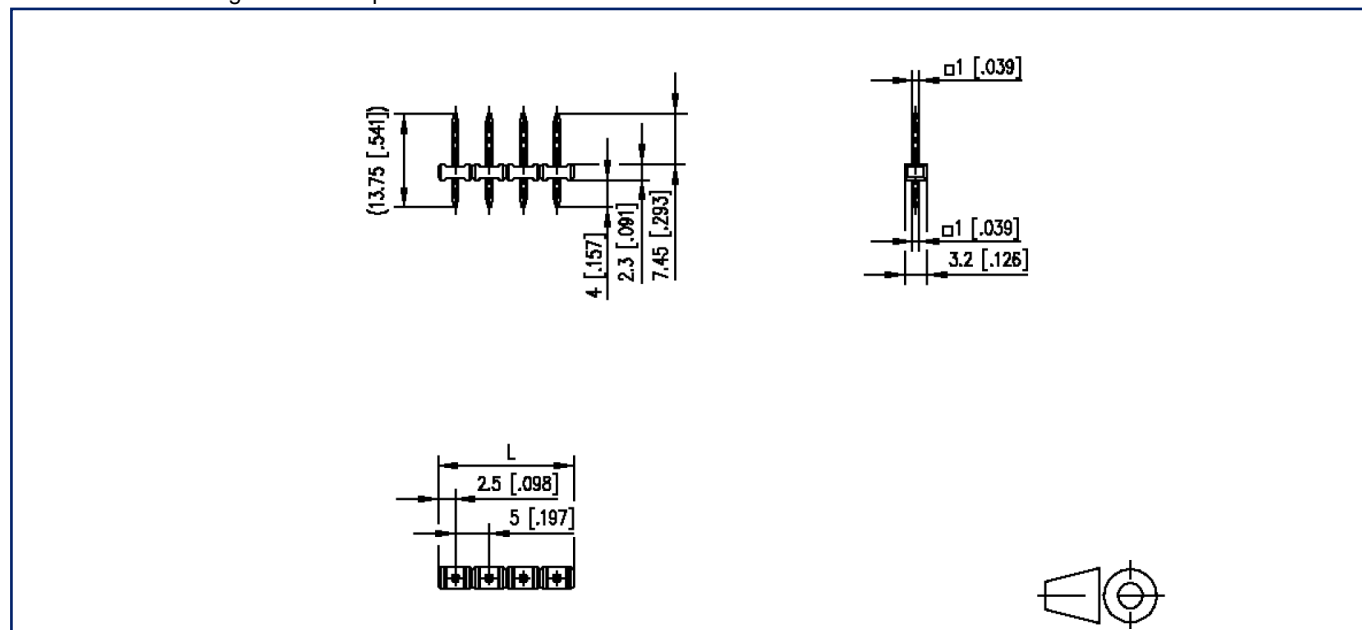

$L = (\text{pole size} - 1) \times \text{centerline} + 5 \text{ mm} [0.197]$

U | Contact

Data sheet

PR055xxVBHC Type 048

Page 6/6

P/N

310481xx

xx=number of poles

2025/04/16

Version: AA

Illustrations

Drill pattern as an example

