

## Data sheet

RP033xxVBLC Type 339

Page 1/5

P/N

313391xx

xx=number of poles

2025/04/30

Version: U

### Illustrations



Dimensional drawing as an example

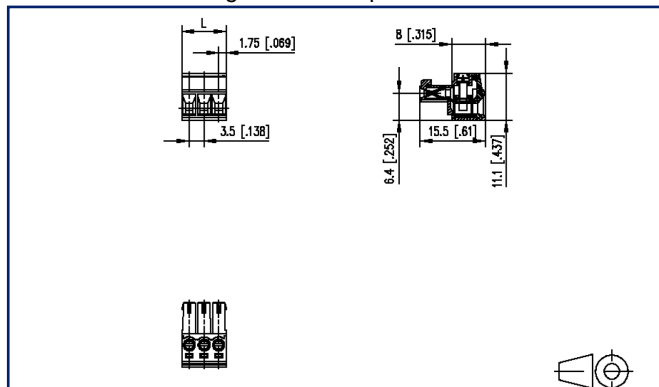

See enlarged drawings at the end of document

### Product specification

- screw type terminal block, pluggable
- centerline 3.50 mm, direction of connection vertical 0°
- lift system, fittable without loss of poles
- color black
- wire entry codeable side perpendicular to plug direction



## Data sheet RP033xxVBLC Type 339

Page 2/5

P/N  
313391xx

xx=number of poles

2025/04/30

Version: U

### Technical Data



#### General Data

Tightening torque SEV	0.25 Nm		
Tightening torque UL	2.2 lb-in		
min. number of poles	2		
max. number of poles	12		
Insulating material class	CTI 600		
clearance/creepage dist.	2.2 mm		
Protection category	IP20		
Insul. strip length	6 mm		
Rated current	12 A		
Overvoltage category	III	III	II
Pollution degree	3	2	2
Rated voltage	63 V	320 V	320 V
Rated test voltage	2.5 kV	2.5 kV	2.5 kV

#### Terminal data

rat.wiring solid AWGmax	0.08 mm <sup>2</sup> - 1.5 mm <sup>2</sup> / AWG 28 - AWG 16
rat.wiring strand.AWGmax	0.08 mm <sup>2</sup> - 1.5 mm <sup>2</sup> / AWG 28 - AWG 16

#### Approvals

 V / A / AWG	300 / 8 / 28 - 16
approval UL - File No.	E121004
	125 V / 2.5 kV / 9 A

#### Material

insulating material	PA66
flammability class	V0
contact material	CuSn
Contact surface	Sn
terminal body thread	M2
terminal body material	CuZnPb
terminal body surface	Ni
screw thread	M2
screw material	8,8

# U | Contact

## Data sheet

## RP033xxVBLC Type 339

Page 3/5

P/N

313391xx

xx=number of poles

2025/04/30

Version: U

### Technical Data

screw surface	Cu + Ni
Glow-Wire Flammability GWFI	960 °C acc. to IEC 60695-2-12
Glow-Wire Flammability GWIT	775 °C acc. to IEC 60695-2-13

### Climatic Data

upper limit temperature	105 °C
lower limit temperature	-40 °C

### general

Tolerance	ISO 2768 -mH
-----------	--------------

### Application note

This product is a standard product of METZ CONNECT. METZ CONNECT is not aware of the specific intended use of the goods by the Customer or any customers of the Customer. The Customer guarantees that it has fully and sufficiently tested the use of the goods and any product modifications, product changes or product enhancements with regard to the specific intended use in accordance with the state of the art or in any other way. At METZ CONNECT's request, the Customer shall submit and make available meaningful evidence (e.g. test and laboratory protocols, certifications, etc.).



# U | Contact

Data sheet

Page 4/5

**RP033xxVBLC Type 339**

P/N

**313391xx****xx=number of poles**

2025/04/30

Version: U

## Counterpart

P/N	Designation
311881	PR043xxHBBN Type 188
311891	PR043xxVBBN Type 189
313421	PT093xxHBBN Type 342
313431	PT093xxVBBN Type 343



# U | Contact

Data sheet

RP033xxVBLC Type 339

Page 5/5

P/N

313391xx

xx=number of poles

2025/04/30

Version: U

## Illustrations

Dimensional drawing as an example

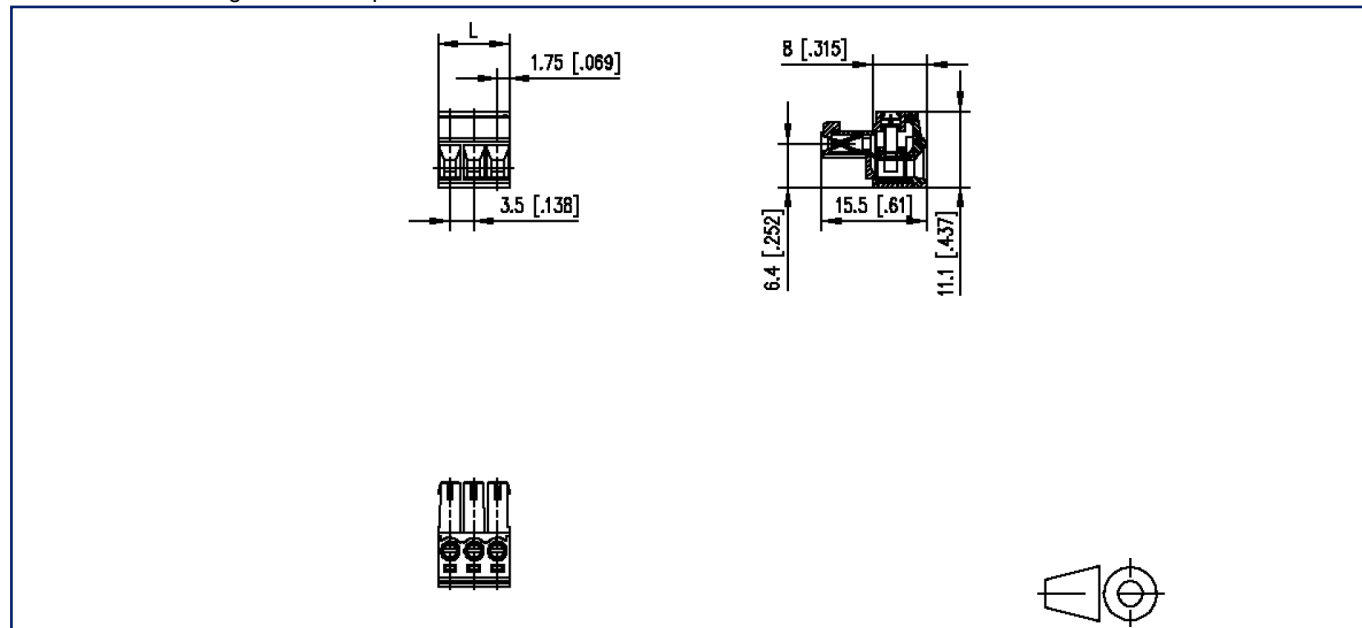

$L = (\text{pole size} - 1) \times \text{centerline} + 3.5 \text{ mm} [0.138]$